

Phosphor  
Bronze

# Flush Head

# Broaching Stud

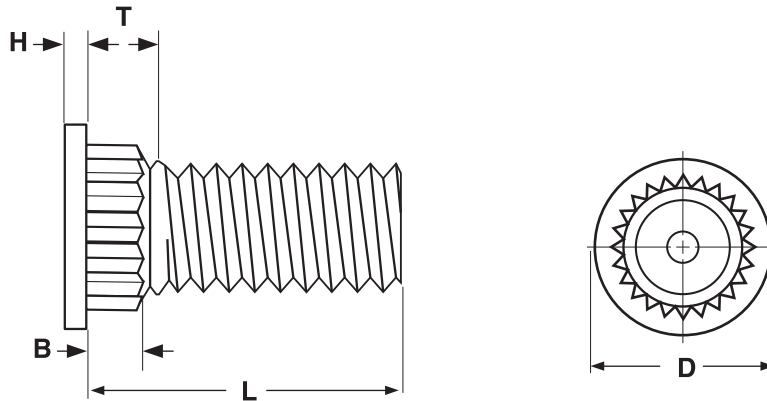

BROACHING TYPE STUDS												PEM®
Thread Size	D		H		B	T	Sheet Thickness	Hole Size in Sheet		Clearance Hole size in Attached Parts	Distance from Hole Center to Edge	
	Head Diameter		Head Height		Shank	Distance to first full form thread		Max	Min			
	Max	Min	Max	Min	Max	Max	Min			Max	Min	Max
4-40	.190	.170	.025	.015	.065	.09	.060	.123	.120	.145	.15	
6-32	.210	.190	.025	.015	.065	.09	.060	.143	.140	.170	.19	
8-32	.235	.215	.025	.015	.065	.09	.060	.169	.166	.195	.20	
10-32	.260	.240	.025	.015	.065	.09	.060	.192	.189	.220	.20	
Tolerance on Length					± .010							

<b>Description</b>	An externally threaded fastener with unified thread pitch and a circular, low-profile head. Directly below the head is a shoulder with a series of ribs that extend vertically from the head to above the first full form thread. The diameter of the ribbed area is greater than the major diameter of the threaded shank.
<b>Applications/ Advantages</b>	Designed for use in personal computer boards as either (a) a permanently affixed mechanical fastener that holds its place, or (b) as a connector that can be soldered.
<b>Material</b>	CDA 510 Phosphor Bronze
<b>For use in...</b>	...materials with a hardness of Rockwell B-65 or less.
<b>Installation Force</b>	400 lbs. (all diameters)
<b>Nut Tightening Torque (Max.)</b>	4-40: 4 in. lbs.; 6-32: 8 in. lbs.; 8-32: 15 in. lbs.; 10-32: 18 in. lbs.
<b>Pushout</b>	4-40: 65 lbs.; 6-32: 70 lbs.; 8-32: 80 lbs.; 10-32: 90 lbs.
<b>Torque Out</b>	4-40: 7 in. lbs.; 6-32: 11 in. lbs.; 8-32: 16 in. lbs.; 10-32: 17 in. lbs.
<b>Plating</b>	Electro-tin plated